

PRELIMINARY PLAT OF

# LAKE HILLS SUBDIVISION - TWENTY-FIFTH FILING AMENDED

BEING LOTS 1 THROUGH 7, BLOCK 65, LOTS 1 THROUGH 13 OF BLOCK 62 AND LOTS 1 THROUGH 12 AND LOT 28 OF BLOCK 63

SAID TRACT OF LAND IS SITUATED IN THE SE 1/4 OF SECTION 9, T. 1 N., R. 26 E., P.M.M.,

CITY OF BILLINGS, YELLOWSTONE COUNTY, MONTANA

FOR: SUSAN B. LOVELY INC.

BY: HKM ENGINEERING INC.

P.O. BOX 31318  
BILLINGS, MT 59107

DATE: FEBRUARY 2008

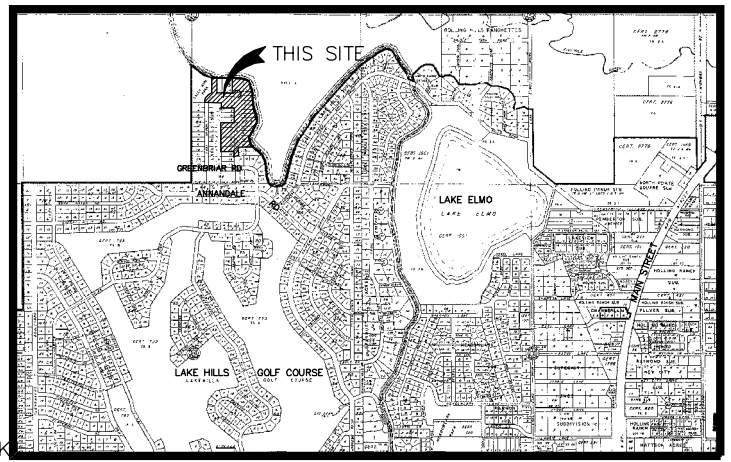

VICINITY MAP

**EXISTING UTILITIES**

- FIRE HYDRANT
- VALVE
- CURB STOP
- MANHOLE
- STORM DRAIN CURB INLET
- STORM DRAIN AREA INLET
- SANITARY SEWER SERVICE
- WATER LINE
- SANITARY SEWER LINE
- STORM DRAIN LINE
- CURB & GUTTER

**NEW UTILITIES**

- FIRE HYDRANT
- VALVE
- WATER SERVICE
- CURB STOP
- TEE
- CROSS
- TEE OR CROSS PROFILE
- 90° BEND
- BENDS
- WATER WELL
- MANHOLE
- STORM DRAIN CURB INLET
- STORM DRAIN AREA INLET
- SANITARY SEWER SERVICE
- WATER LINE
- SANITARY SEWER LINE
- STORM DRAIN LINE

**ADJACENT PROPERTY OWNERS**

Unplatted to West, North, and East  
Dover Ranch  
633 Sindelar Road  
Billings, MT 59105

Lot 1, Block 64, Lake Hills Sub. 25th  
D & M Family, LP  
1808 Old Sorrel Trail  
Billings, MT 59105

Lot 27, Block 63, Lake Hills Sub. 25th  
Thomas X. Dahinden  
Tanya L. Dahinden  
2545 Lake Heights Drive  
Billings, MT 59105

Lot 26, Block 63, Lake Hills Sub. 25th  
M&M Contracting Inc.  
1921 Wentworth Drive  
Billings, MT 59105

Lot 25, Block 63, Lake Hills Sub. 25th  
Nelly & Luz Baca  
1240 Pricedale Avenue  
West Covina, CA 91790

Lot 24, Block 63, Lake Hills Sub. 25th  
William O. Bahny  
P.O. Box 4895  
Helena, MT 59601

Lot 23, Block 63, Lake Hills Sub. 25th  
Seth F. Lee  
2521 Lake Heights Drive  
Billings, MT 59105

Lots 22 & 20, Block 63, Lake Hills Sub. 25th  
Susan B. Lovely Inc.  
Laure Taylor Inc.  
2519 Sunnyview Lane  
Billings, MT 59102

Lot 21, Block 63, Lake Hills Sub. 25th  
Brett M. Fletcher  
Jay Clark  
340 Tahos Road  
Orinda, CA 94563

Lot 19, Block 63, Lake Hills Sub. 25th  
Lynn J. & Margaret C. Murphy  
2441 Lake Heights Drive  
Billings, MT 59105

Lot 18, Block 63, Lake Hills Sub. 25th  
Kerry S. & Terri Ashment  
2435 Lake Heights Drive  
Billings, MT 59105

Lot 17, Block 63, Lake Hills Sub. 25th  
George O. III & Cynthia M. Rabidou  
2427 Lake Heights Drive  
Billings, MT 59105

Lot 16, Block 63, Lake Hills Sub. 25th  
Ralph R. & Linda C. Heppner  
2421 Lake Heights Drive  
Billings, MT 59105

Lot 13, Block 63, Lake Hills Sub. 25th  
Kent W. & Merry L. Richmond  
2420 Ditton Drive  
Billings, MT 59105

Lot 14, Block 62, Lake Hills Sub. 25th  
John C. & Mary C. Cutler  
2717 Ditton Road  
Billings, MT 59105

Lot 15, Block 62, Lake Hills Sub. 25th  
Randy L. & Susan E. Morgan  
2429 Greenbriar Road  
Billings, MT 59105

Lot 16, Block 62, Lake Hills Sub. 25th  
Carol Trawick  
2423 Greenbriar Road  
Billings, MT 59105

Lot 17, Block 62, Lake Hills Sub. 25th  
Lance and Nancy K. Doerr  
2417 Greenbriar Road  
Billings, MT 59105

**ADJACENT PROPERTY OWNERS**

Lots 4, 5 & 6, Block 65, Lake Hills Sub. 25th  
Julia Lawrence  
1299 Wicks Lane  
Billings, MT 59105

Lot 3, 4 & 5, Block 63, Lake Hills Sub. 25th  
Erven M. Roll  
Leona Roll  
921 Miles Avenue  
Billings, MT 59101

Lot 12 & 13, Block 62, Lake Hills Sub. 25th  
Walter Herman  
Genevieve C. Herman  
1406 Redwing Circle  
Billings, MT 59105

Lot 13, Block 63, Lake Hills Sub. 25th  
Kent W. Richmond  
Merry L. Richmond  
2420 Ditton Drive  
Billings, MT 59105

Lot 12, Block 63, Lake Hills Sub. 25th  
Brett M. Fletcher  
Jay Clark  
340 Tahos Road  
Orinda, CA 94563

Lot 19, Block 63, Lake Hills Sub. 25th  
Lynn J. & Margaret C. Murphy  
2441 Lake Heights Drive  
Billings, MT 59105

Lot 18, Block 63, Lake Hills Sub. 25th  
Kerry S. & Terri Ashment  
2435 Lake Heights Drive  
Billings, MT 59105

Lot 17, Block 63, Lake Hills Sub. 25th  
George O. III & Cynthia M. Rabidou  
2427 Lake Heights Drive  
Billings, MT 59105

Lot 16, Block 63, Lake Hills Sub. 25th  
Ralph R. & Linda C. Heppner  
2421 Lake Heights Drive  
Billings, MT 59105

Lot 13, Block 63, Lake Hills Sub. 25th  
Kent W. & Merry L. Richmond  
2420 Ditton Drive  
Billings, MT 59105

Lot 14, Block 62, Lake Hills Sub. 25th  
John C. & Mary C. Cutler  
2717 Ditton Road  
Billings, MT 59105

Lot 15, Block 62, Lake Hills Sub. 25th  
Randy L. & Susan E. Morgan  
2429 Greenbriar Road  
Billings, MT 59105

Lot 16, Block 62, Lake Hills Sub. 25th  
Carol Trawick  
2423 Greenbriar Road  
Billings, MT 59105

Lot 17, Block 62, Lake Hills Sub. 25th  
Lance and Nancy K. Doerr  
2417 Greenbriar Road  
Billings, MT 59105

**SITE DATA**

NUMBER OF LOTS:	29
MAXIMUM LOT AREA:	19388 sq. ft.
MINIMUM LOT AREA:	9999 sq. ft.
AREA OF PARKLAND:	PREVIOUSLY DEDICATED
LINEAL FEET OF STREETS: (INCL. PREV. DEDICATIONS)	1693 ft.
AREA OF STREET R/W: (NEW DEDICATIONS)	0.41 acres
GROSS ACREAGE:	9.44 acres
NET ACREAGE: (LOTS)	9.03 acres
ZONING	EXISTING: RESIDENTIAL 9600 PROPOSED: RESIDENTIAL 9600
LAND USE	EXISTING: RESIDENTIAL (SINGLE FAMILY) PROPOSED: RESIDENTIAL (SINGLE FAMILY)

